

MANUFATTO DI RESTITUZIONE - AREA GOLENALE 5

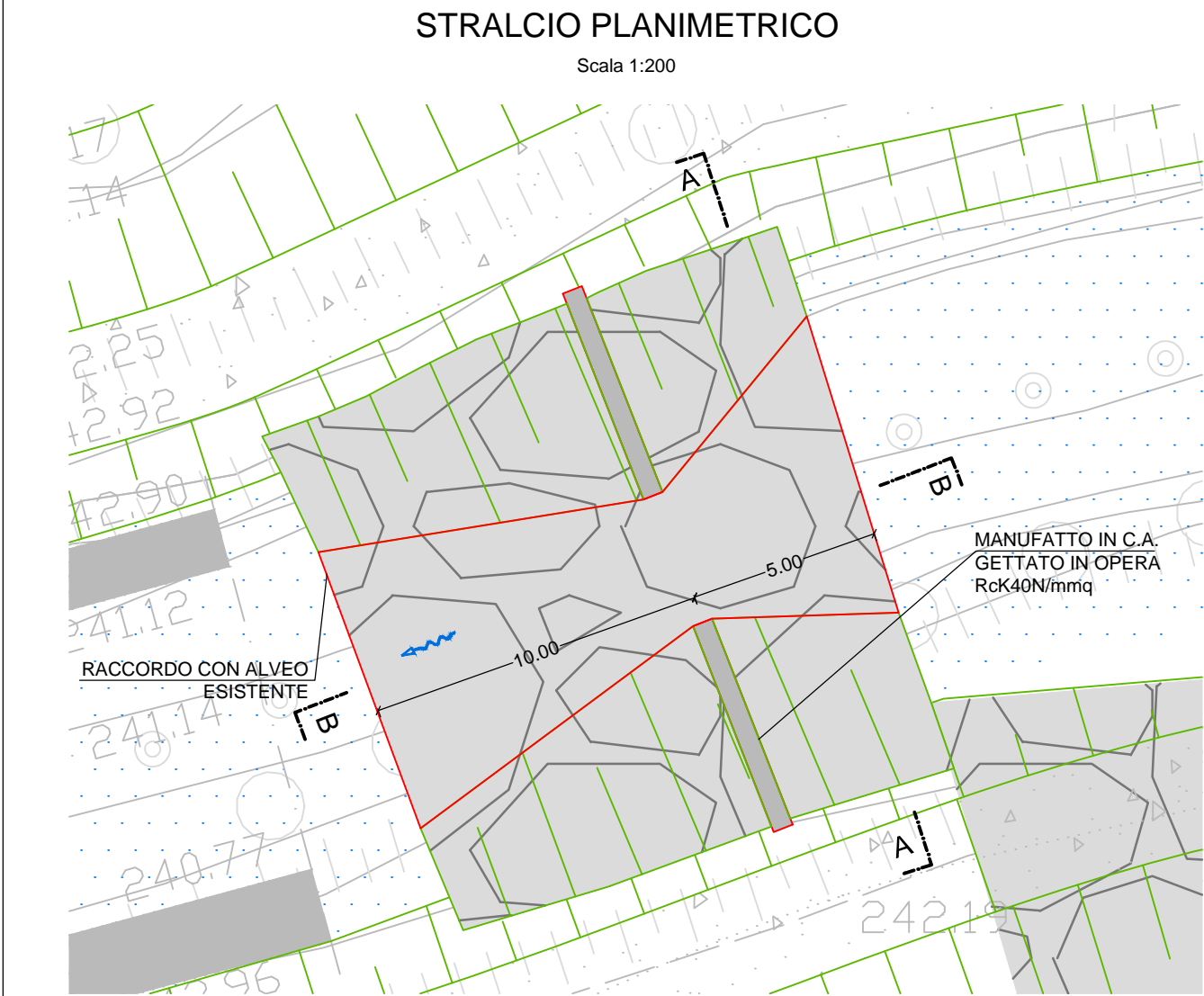

MANUFATTO DI RESTRINGIMENTO - AREA GOLENALE 5

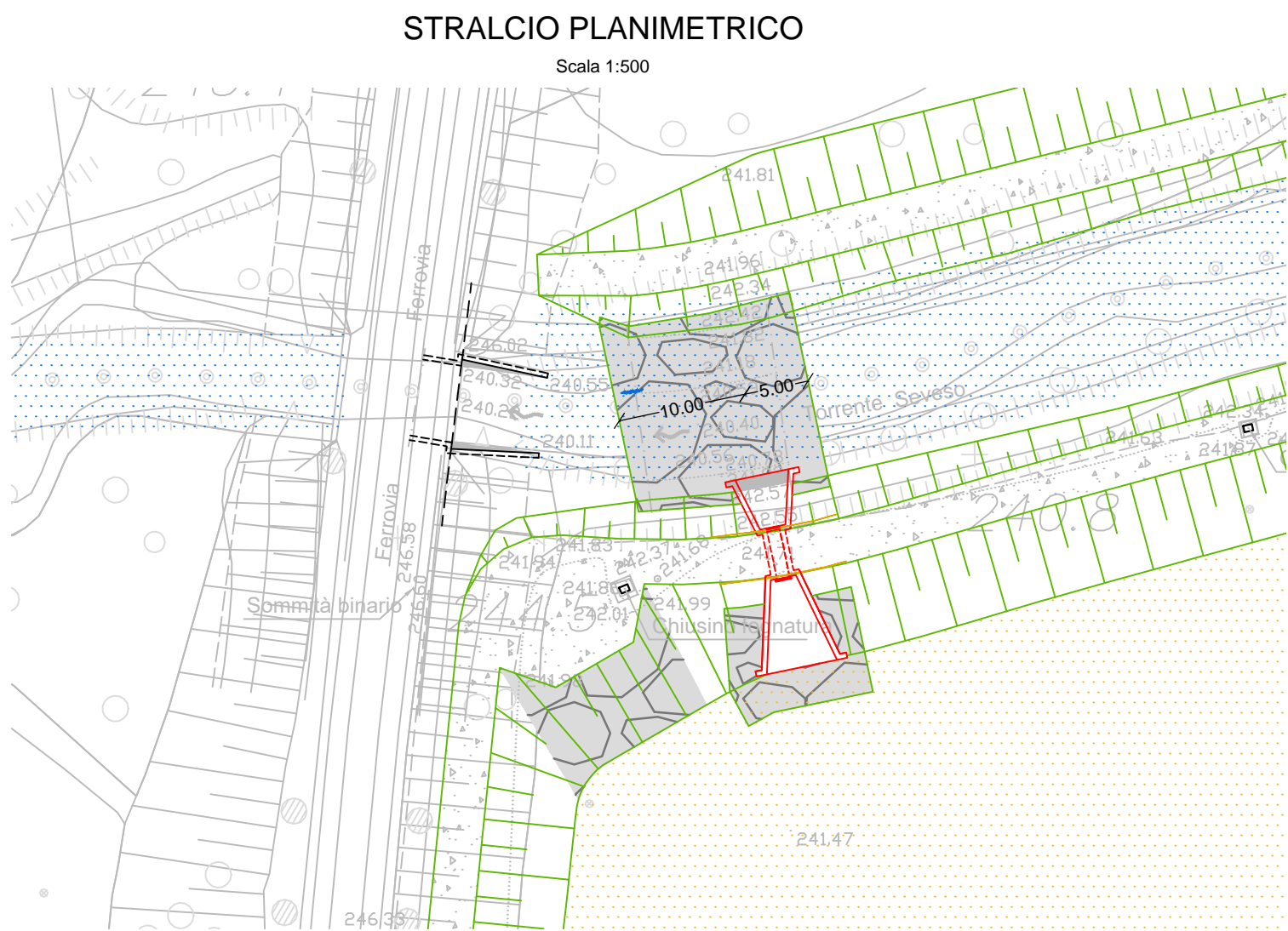
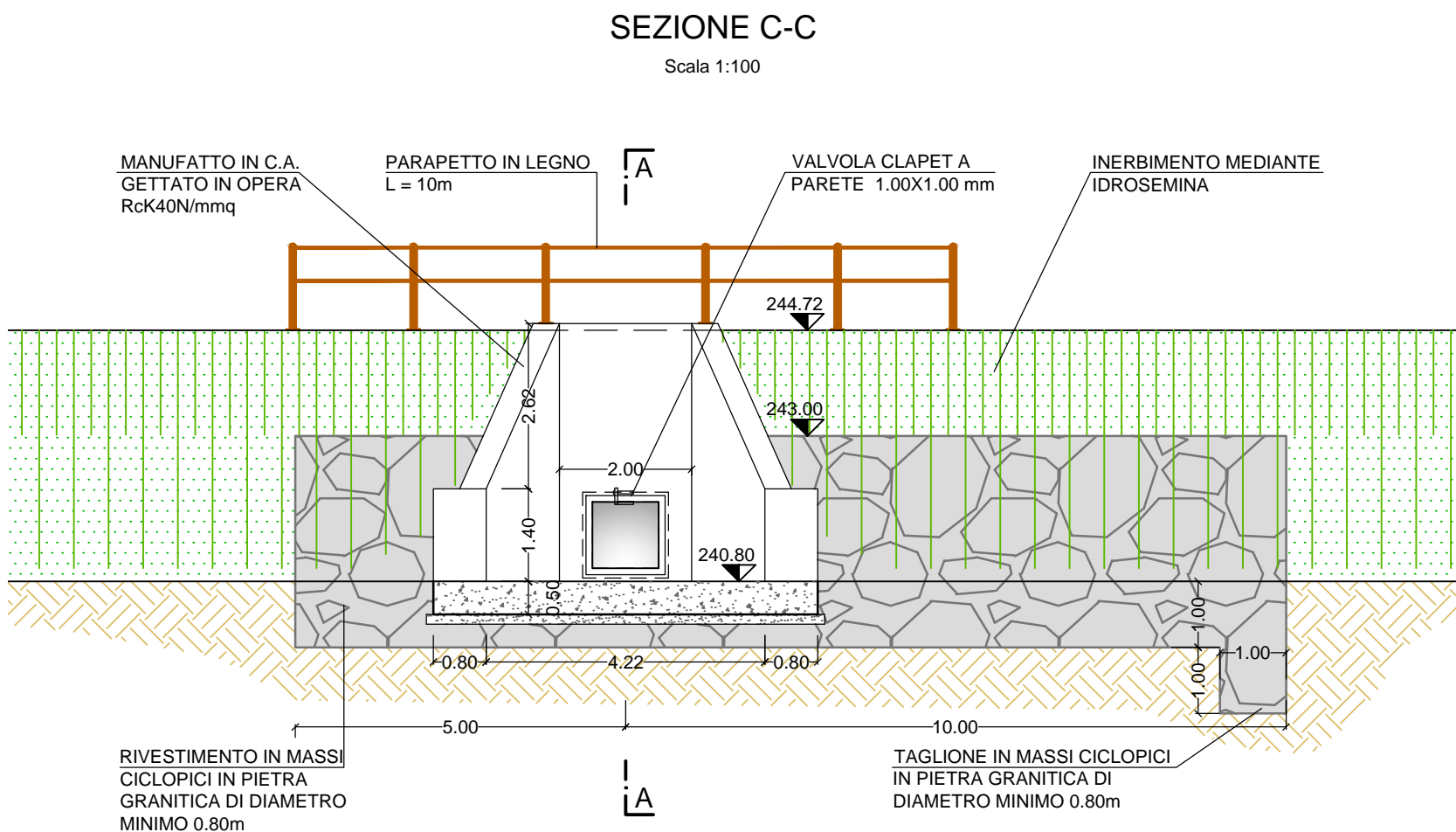
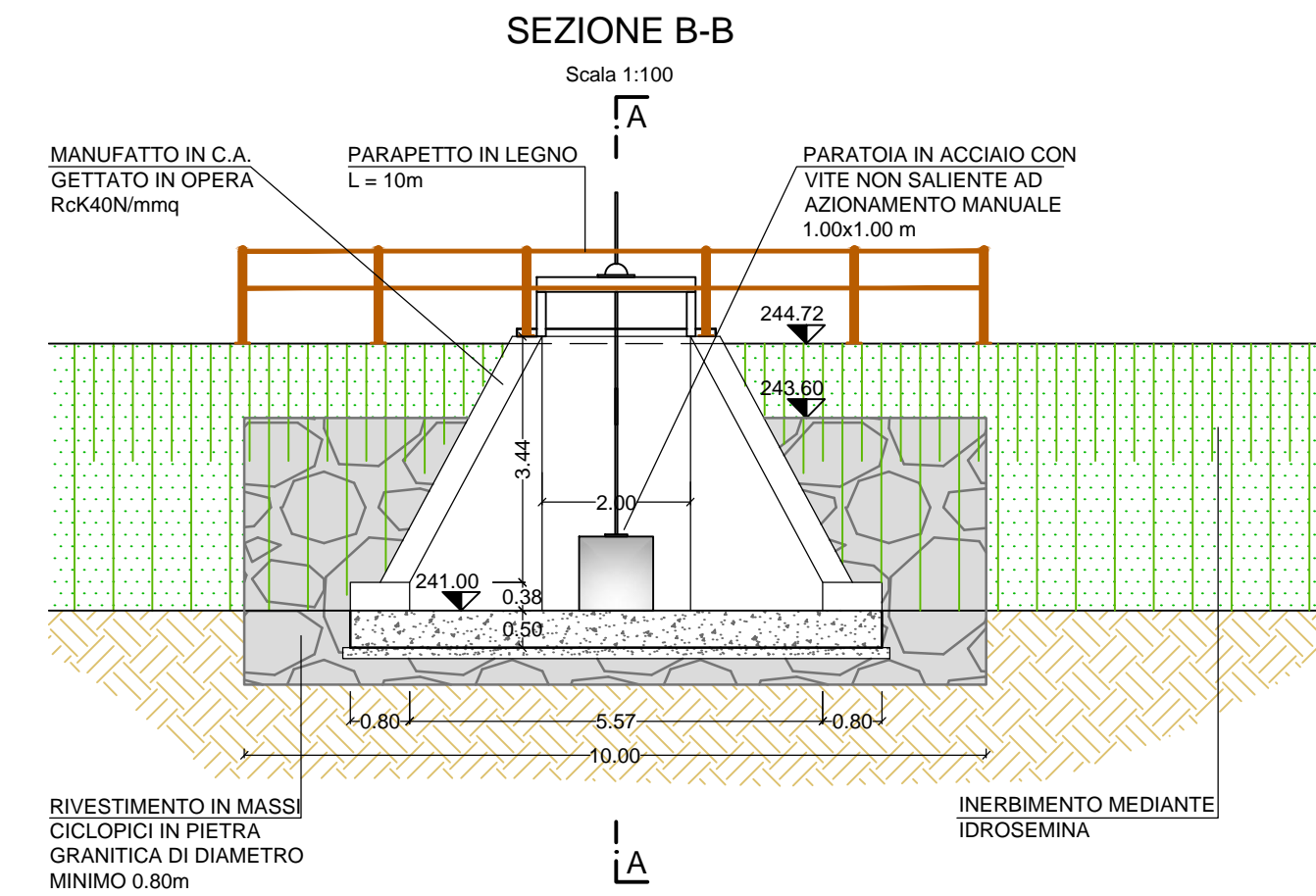
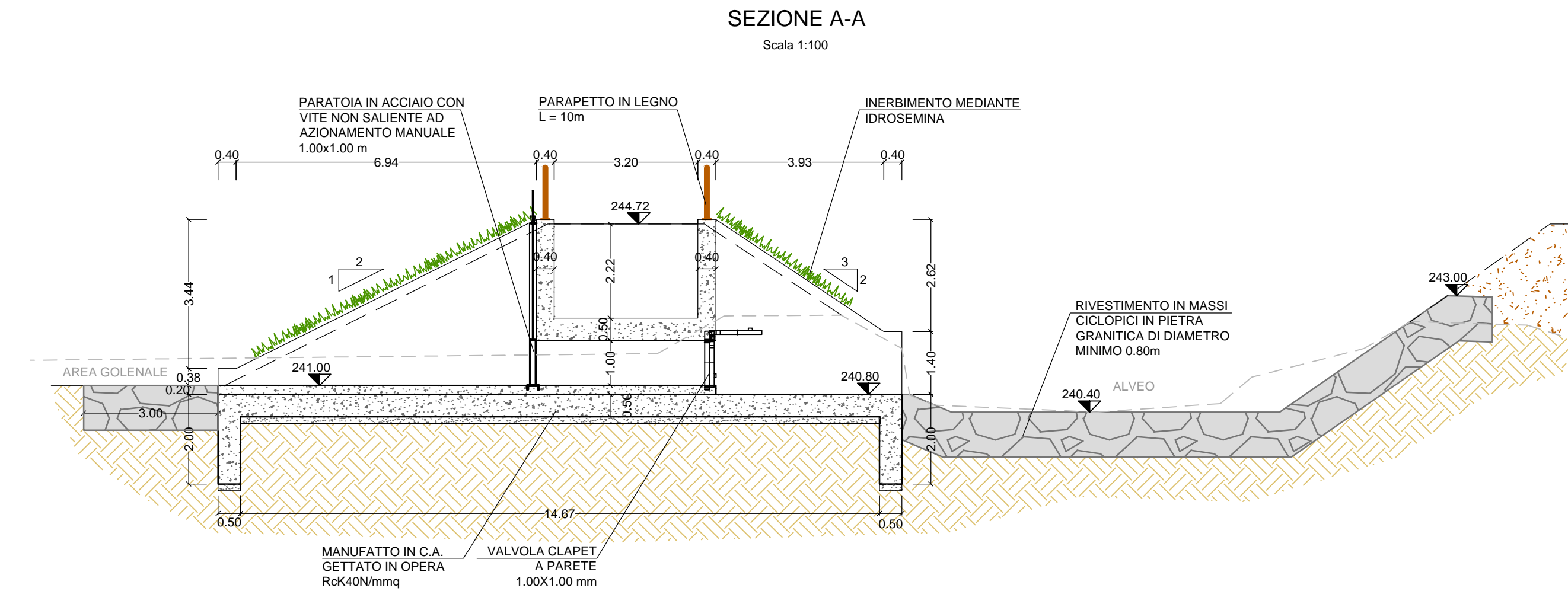
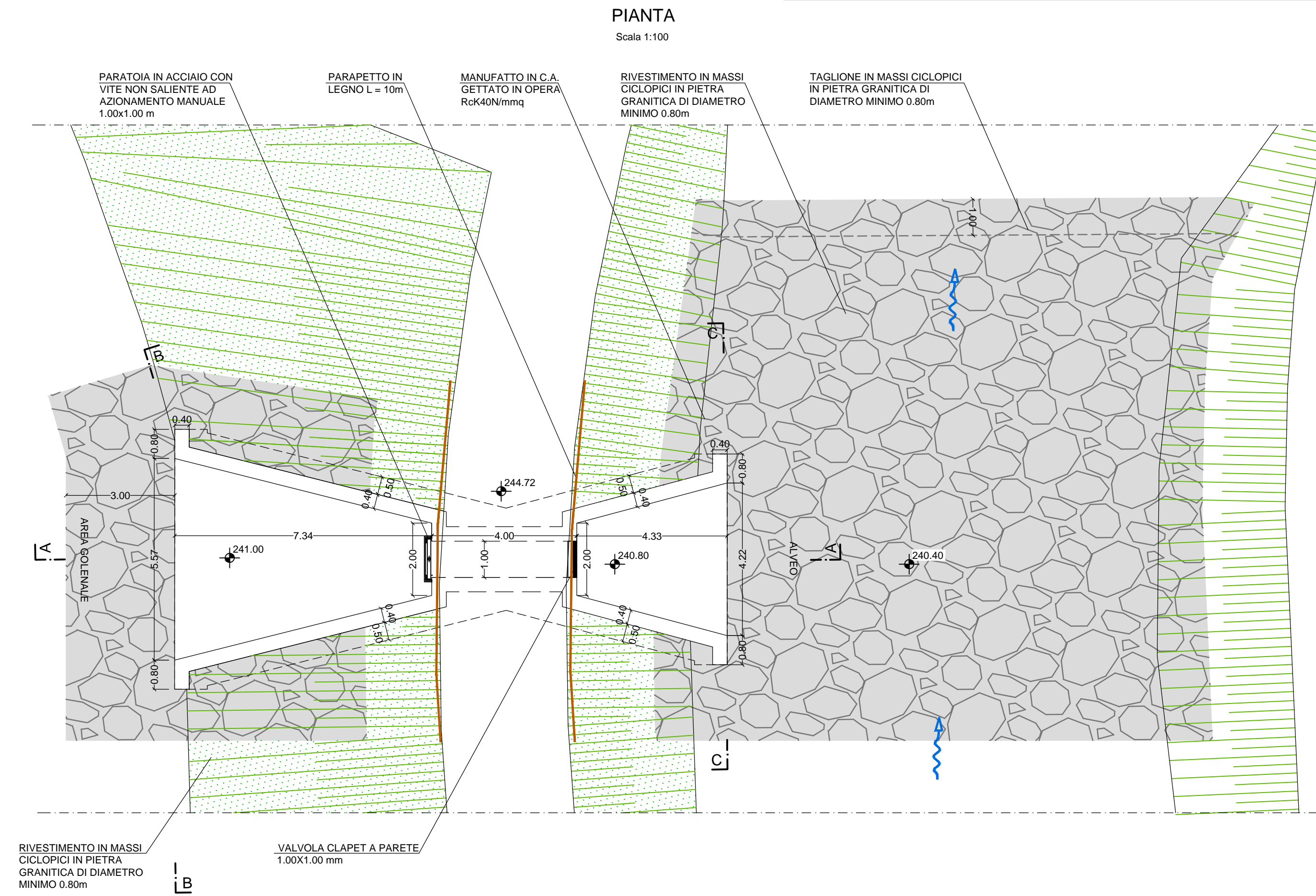
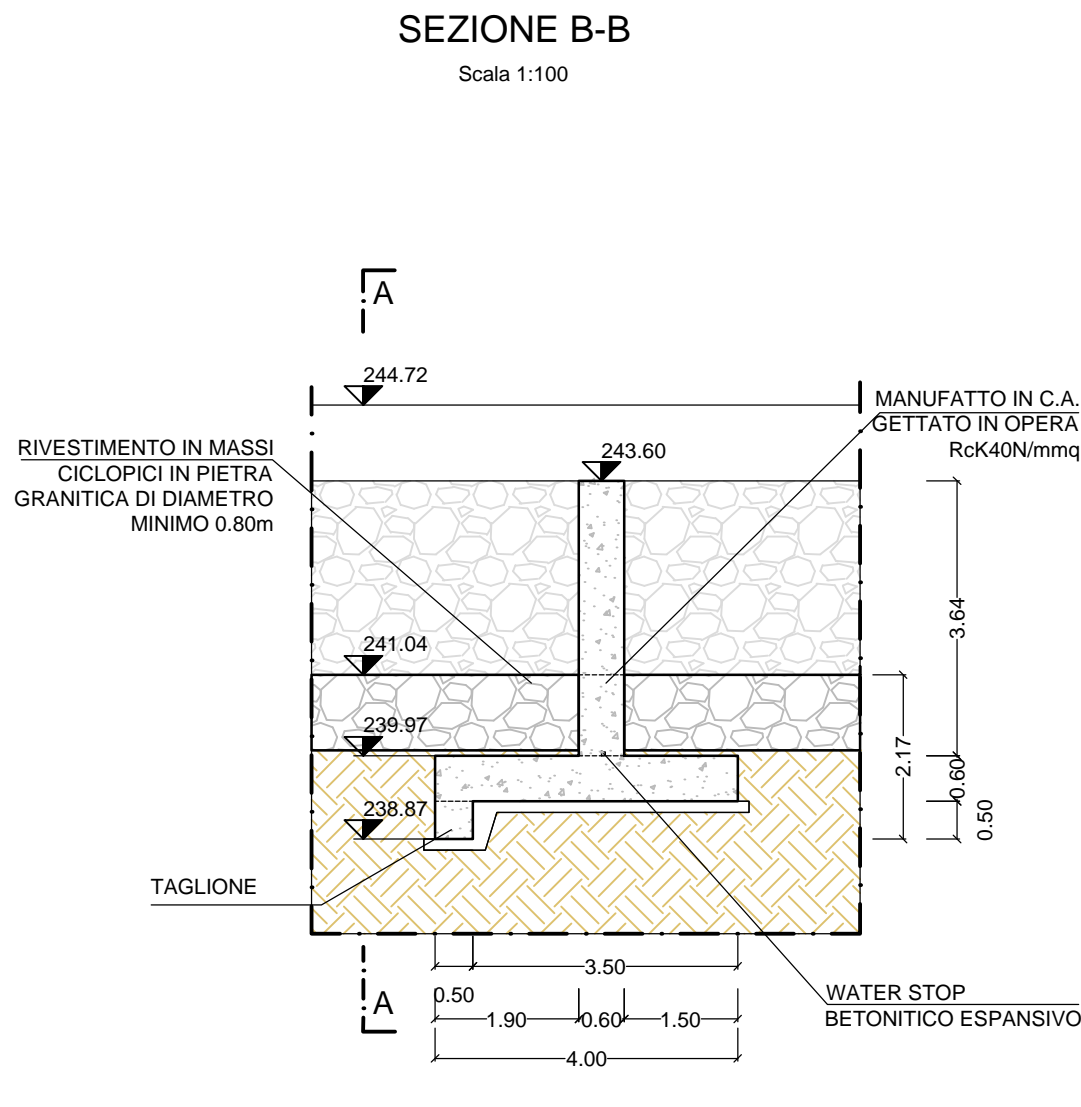
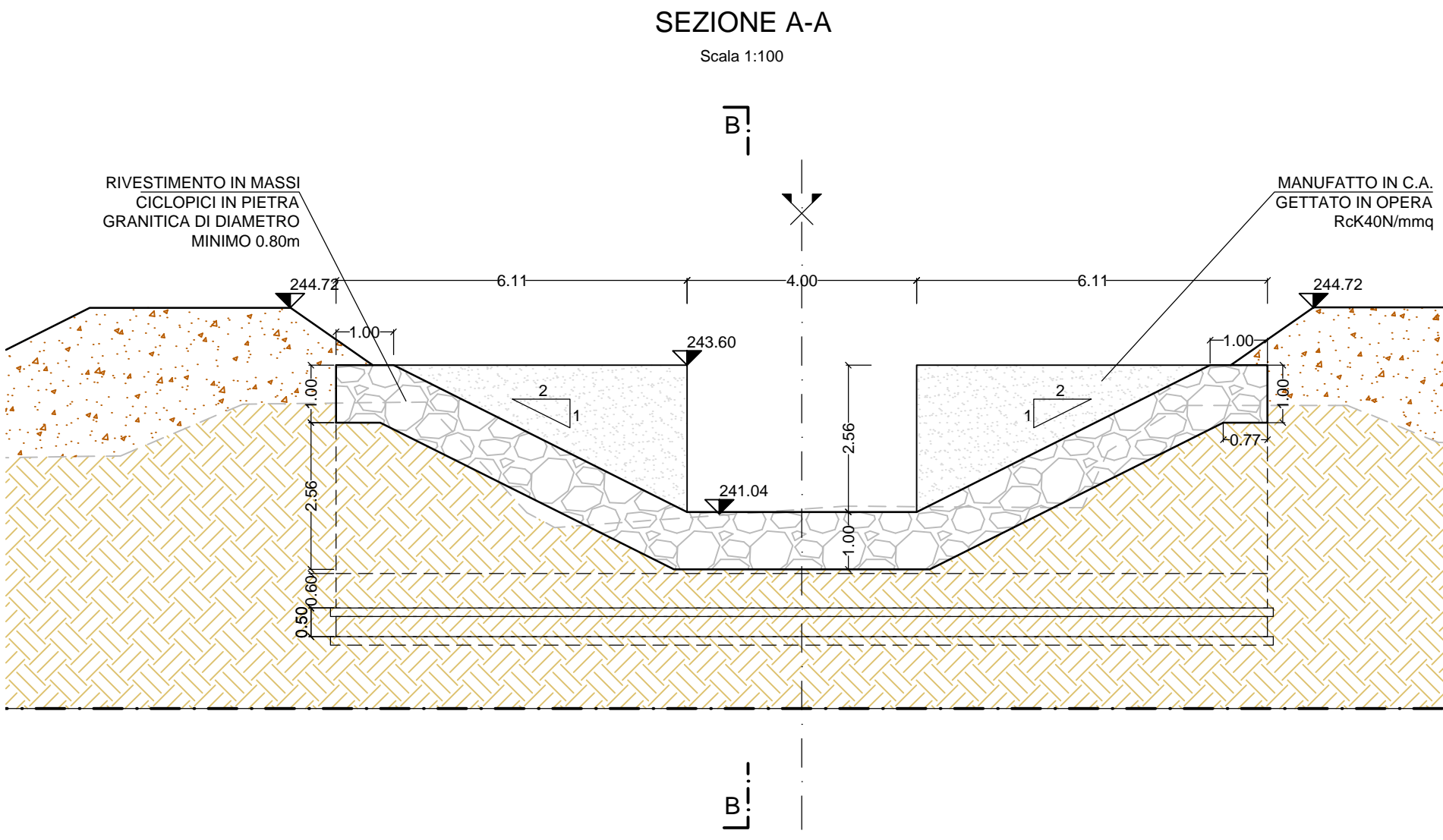

AREE GOLENALI DEL FIUME SEVESO NEI
COMUNI DI VERTEMATE CON MINOPRIO,
CARIMATE E CANTÙ

PROGETTO DEFINITIVO

00	06/2016	Emissione a seguito di nota AIPo prot. n. 00015532/2016 del 15.06.2016			
INDICE	DATA	MODIFICHE	DISEGN.	CONTR.	APPROV.
AREA GOLENALE 5 Manufatti					
I PROGETTISTI: Dott. Ing. Denis Cerlini Dott. Ing. Alessandro Balbo Dott. Ing. Giacomo Galimberti Dott. Ing. Gaetano di Franca GEOLOGIA: Dott. Geol. Pietro Breviglieri Dott. Geol. Efram Ghezzi			Hanno collaborato: Dott. Ing. Daniele Recalcatti Dott. Ing. Roberta Romiti Geom. Enrico Maddalena Consulenza geotecnica: Dott. Geol. Roberto Prevati		SCALA: INDICATA
STUDIO MAJONE INGEGNERI ASSOCIATI Via Inama, 7 - 20133 Milano - tel. +39.02.70120918 fax +39.02.70120923 Via Cavallotti, 16 - 43121 Parma - tel. +39.0521.508419 fax +39.0521.221022			STUDIO IDROGEOTECNICO		ELABORATO: SVS 2022
MAJONE & PARTNERS DOTT. ING. GAETANO DI FRANCA					Giugno 2016